



VITREOUS CHINA

TOILET  
21-110

LAVATORIES

TOILETS

BIDETS / URINALS

CAST IRON

# MAXWELL® LX Elongated Toilet

10" Rough-in

### Features:

- 1.6 gpf (6.0 Lpf)
- Elongated Front Bowl
- Glazed Trapway
- Reverse Trap
- Front Jet Flushing Action
- Front Tank Lever
- Available in White
- 2 Bolt Caps

### Dimensions:

Height ..... 28 3/4"  
 Width ..... 15 1/2"  
 Depth ..... 27"  
 Rough-in ..... 10"  
 Water Surface from Rim ..... 5 1/2"  
 Trapway ..... 1 3/4"  
 Water Surface ..... 11" x 8"  
 Water Seal ..... 2 1/2"  
 Shipping Weight ..... 64.5 lbs



**Specifications:** Bowl—#21-162 Elongated Bowl  
Seat not included

Tank—#28-195

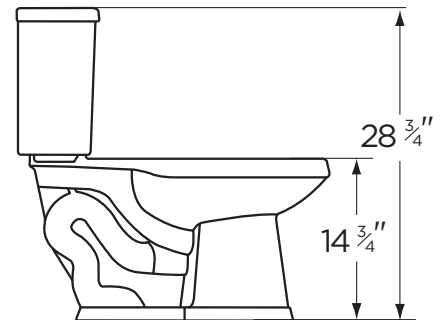
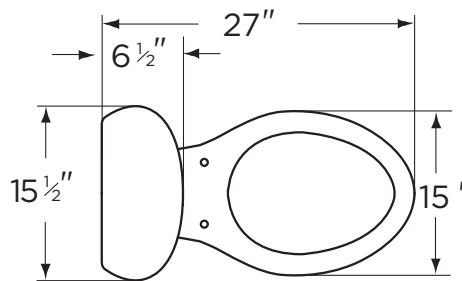

THIS FIXTURE QUALIFIES ACCORDING TO ASME TEST PROCEDURES AS A WATER CLOSET WITH AN AVERAGE CONSUMPTION OF 1.6 gpf (6 Lpf) OR LESS.



[www.gerberonline.com](http://www.gerberonline.com)

Job Name	
Date	
Model Specified	
Quantity	
Customer	
Contractor	
Architect/engineer	



# 1.6 gpf (6.0 Lpf) MAXWELL® LX TOILET

21-110

Elongated, 10" Rough-in  
(Bowl 21-162 with Tank 28-195)

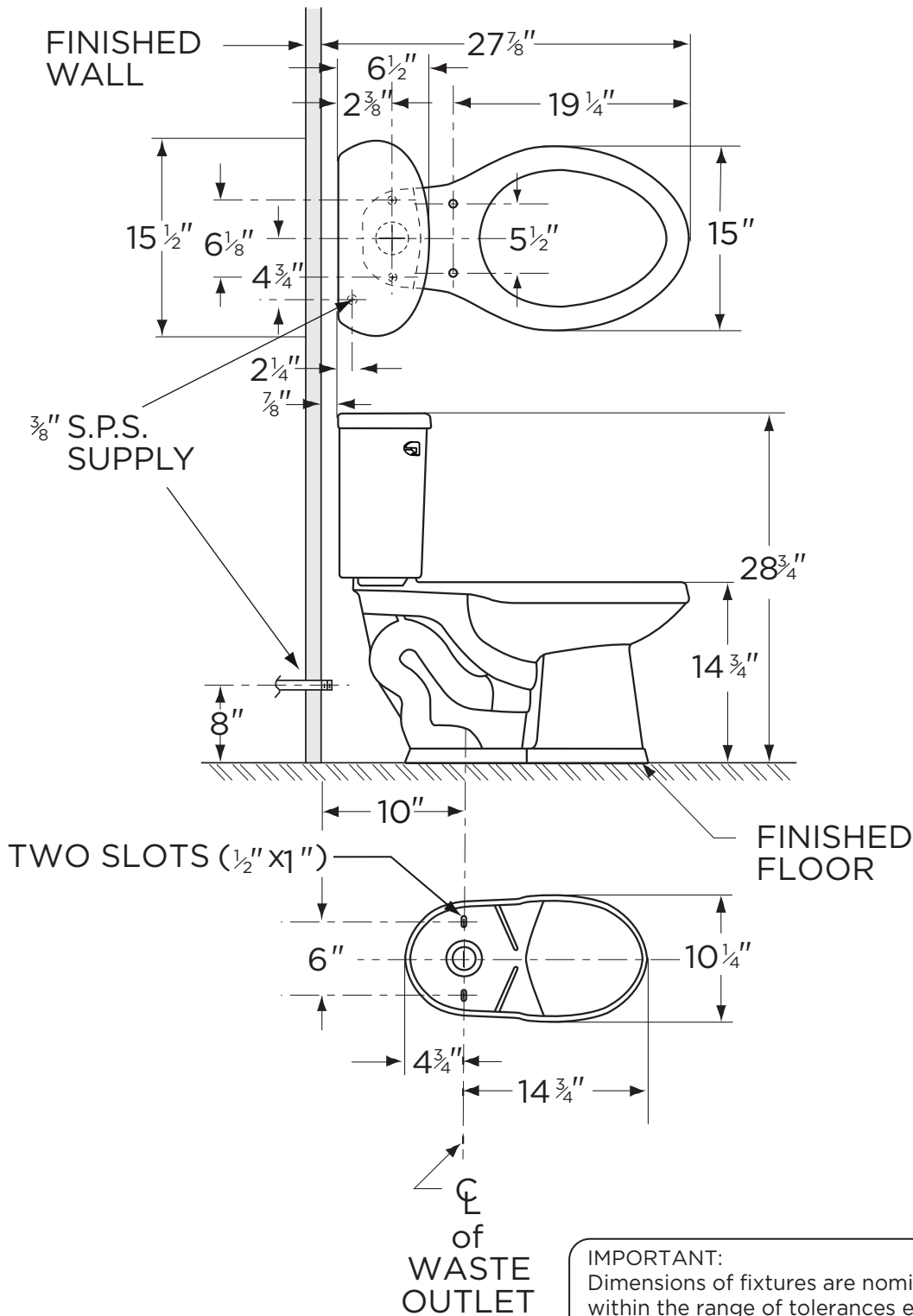

NOTES:  
All dimensions are in inches.  
Illustrations may not be drawn to scale.

**IMPORTANT:**  
Dimensions of fixtures are nominal and may vary within the range of tolerances established by ASME Standard A 112.19.2.  
THIS FIXTURE QUALIFIES ACCORDING TO ASME TEST PROCEDURES AS A WATER CLOSET WITH AN AVERAGE CONSUMPTION OF 1.6 gpf (6 Lpf) OR LESS.